

# MURRAY COUNTY.

Section 7  
10798 McGill-Warner Co., Blank Book Manufacturers, St. Paul.

Township 105

Range 40

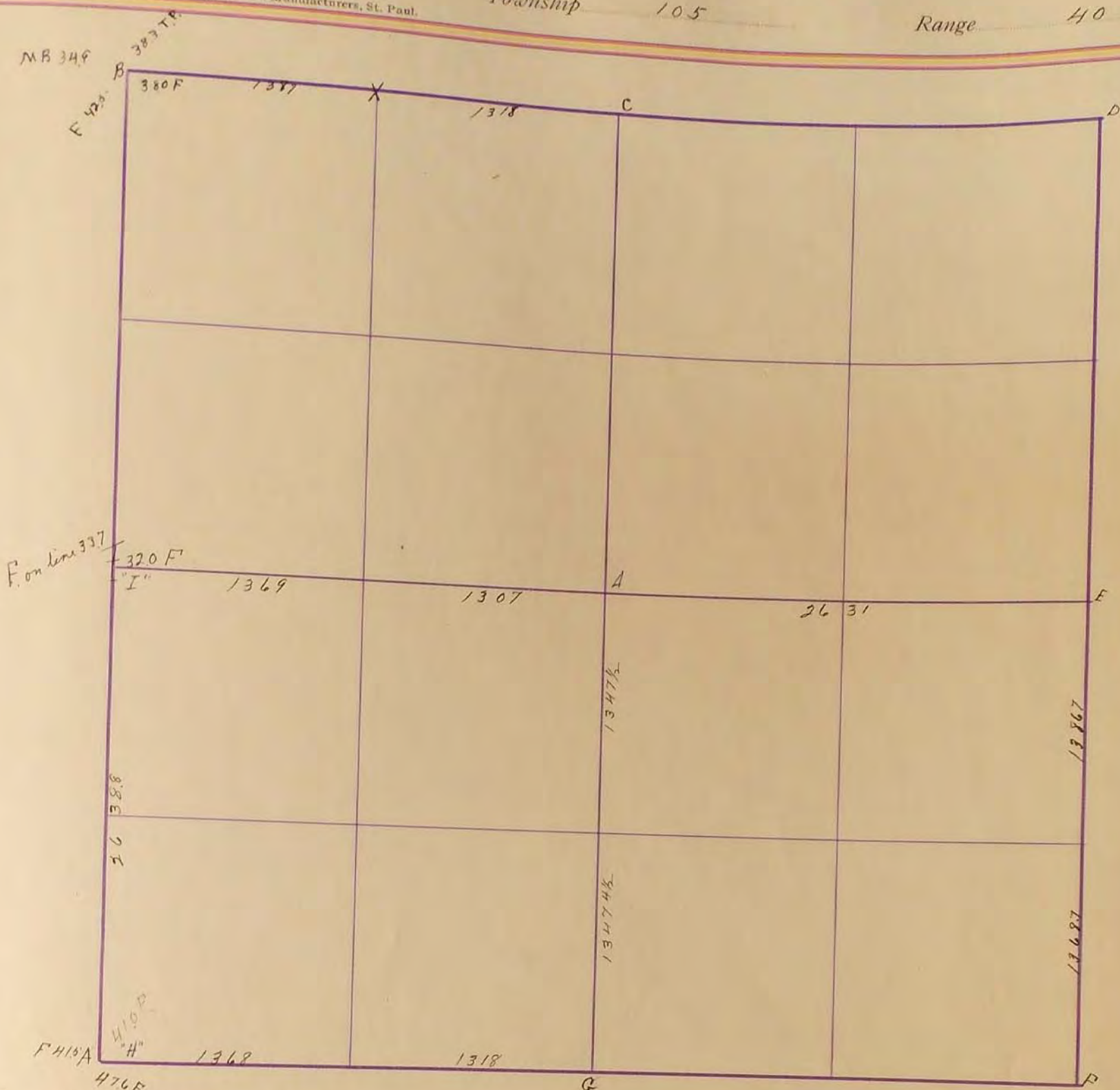

May 17 1900  
Dec 27 - 1897

J. H. Hurlstinecraft

C Stone F cor 259 N 73 W F Post 282 S + H'E

D Stone cottonwood 3' 52.7 SE F cor 432 S W.

X Stone F cor on line 289 S F line 25.9 N.

1/4 Cor. "I" March 29, 1902 Located large pointed field stone  
3.5 ft. below gravel grade - Placed 9" steel fence post above stone:  
R.P., N&C. Cor. Post East 48<sup>70</sup>; R.P., N&C, T.P., SE. 62<sup>71</sup>; R.P., N&C.  
R.P., SW. 61<sup>75</sup>; R.P., N&C, Cor. fence post 52<sup>72</sup> West, @ of gravel  
road top 1.3 West of 1/4 Cor.; R.P. Steel Fe. Post NW. 68<sup>80</sup>  
(post painted red)

"B" NW Cor. Located large flat field stone w/ "X" @ center 2.2' below  
gravel grade March 29, 1902. Placed 9" steel fence Post above  
stone @ gravel grade; R.P., N&C. T.P. NE. 58<sup>81</sup>; R.P., N&C. Brace post  
NW. 63<sup>82</sup>; R.P., N&C, R.P., SW. 61<sup>85</sup>

"H" SW Cor Located Nail in oil mat July 10, 1903; R.P., N&C. Cor. Post  
NE. 60<sup>85</sup>; R.P., N&C. Cor. Post SE. 59<sup>80</sup>; R.P., N&C, R.P. NW. 41<sup>85</sup>

6  
7  
8  
9  
10  
11  
12  
13  
14  
15  
16  
17  
18  
19  
20  
21  
22  
23  
24  
25  
26  
27  
28  
29  
30  
31  
32  
33  
34  
35

SURVEY No. \_\_\_\_\_

MO. 549 Section 4, P. 7  
38.3 F

Town 105

Range 40

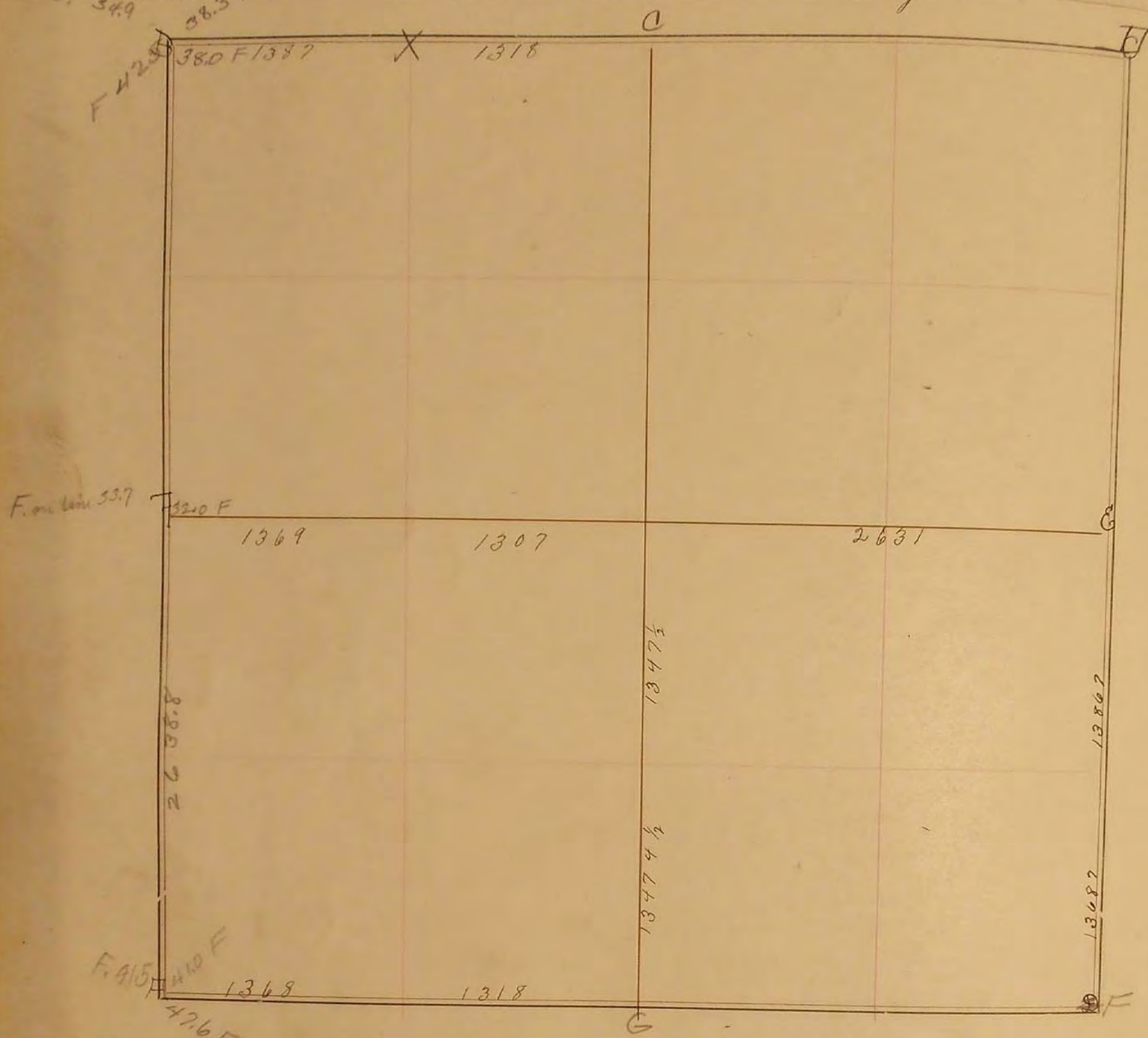

FIELD NOTES.

Mar. 12 1900

Dec. 27 1897

*J. W. Woolstenholme*

C. Stone, F cor. 25.9 N + 3' W, F Post 282 S + 4' E.

H. Stone, Cottonwood 3', 52.7 SE, F cor. 43.2 S.W.

X - Stone, F cor on line 24.95, F line 25.9 N.